

PLAN NO 694  
 FOR THE IMPROVEMENT OF  
**MOUNTAIN VIEW AVENUE**  
 BETWEEN  
 HIGHLAND AVENUE & TWENTY-SEVENTH ST.  
 IN THE  
 CITY OF SAN BERNARDINO  
 November 22nd 1924. CALIFORNIA  
 C.E. Johnson  
 City Engineer.  
 Scale 1"=40'

**LEGEND**  
 " means inch or inches  
 ' means feet or feet  
 St means Street  
 NR means number  
 N on arrow means north  
 Concrete Curbs to be constructed shown thus  
 Concrete Pavement to be constructed shown thus  
 Concrete Roadway in sections shown thus  
 Center Line designated thus &  
 Elev means elevation  
 P.E./W.L. means Pacific Electric Railway

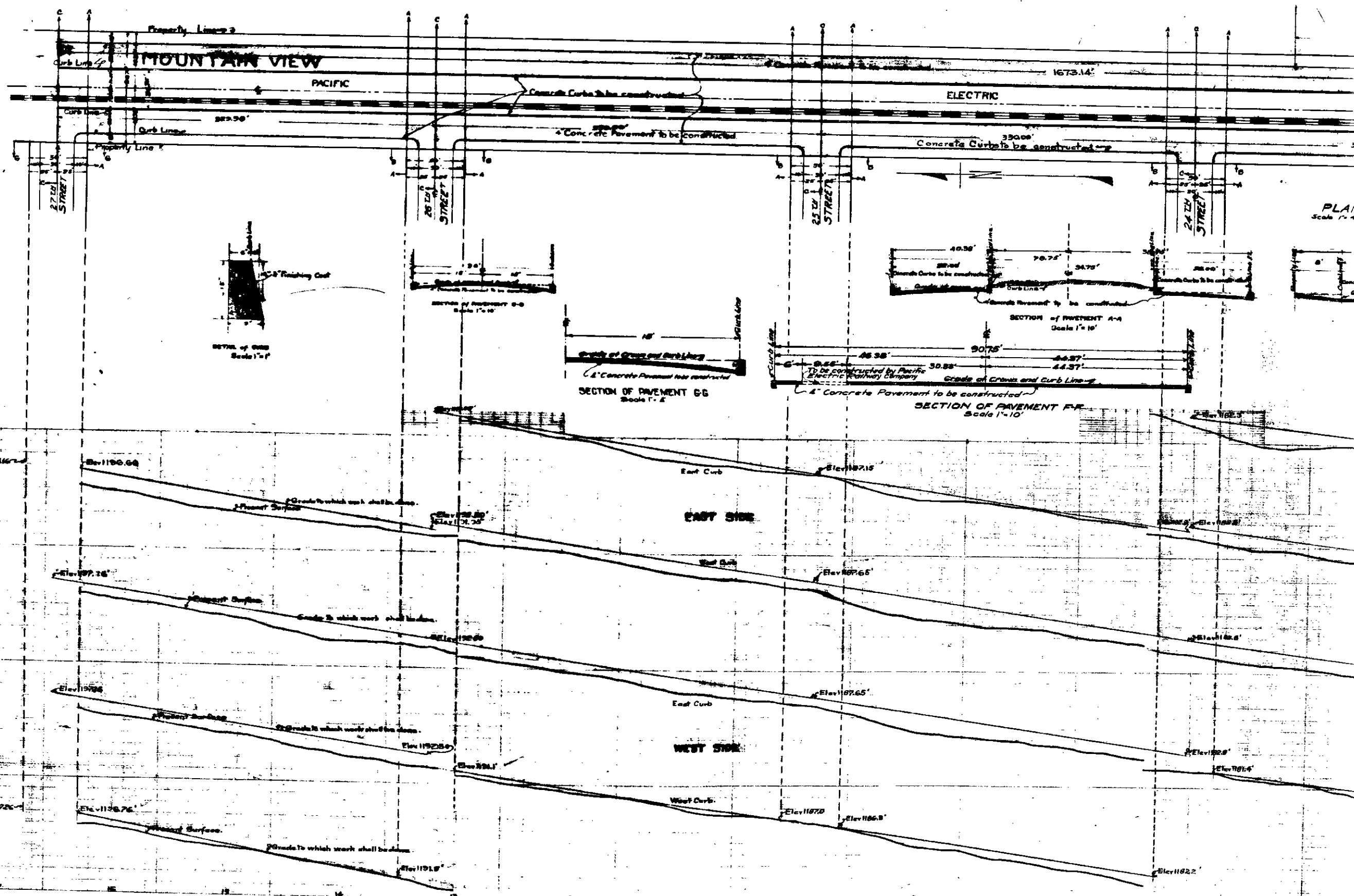

PLAN NO 694  
 FOR THE IMPROVEMENT OF  
**MOUNTAIN VIEW AVENUE**  
 BETWEEN  
 HIGHLAND AVENUE & TWENTY-SEVENTH ST.  
 IN THE  
 CITY of SAN BERNARDINO  
 November 22nd 1926. CALIFORNIA  
 C.E. Johnson  
 City Engineer.  
 Scale 1"=40'

**LEGEND**  
 " means inch or inches  
 ' means feet or feet  
 St means Street  
 NR means number  
 N on arrow means north  
 Concrete Curbs to be constructed shown thus  
 Concrete Pavement to be constructed shown thus  
 Concrete Roadway in sections shown thus  
 Center Line designated thus  
 Elev means elevation  
 P.E./W.L. means Pacific Electric Railway

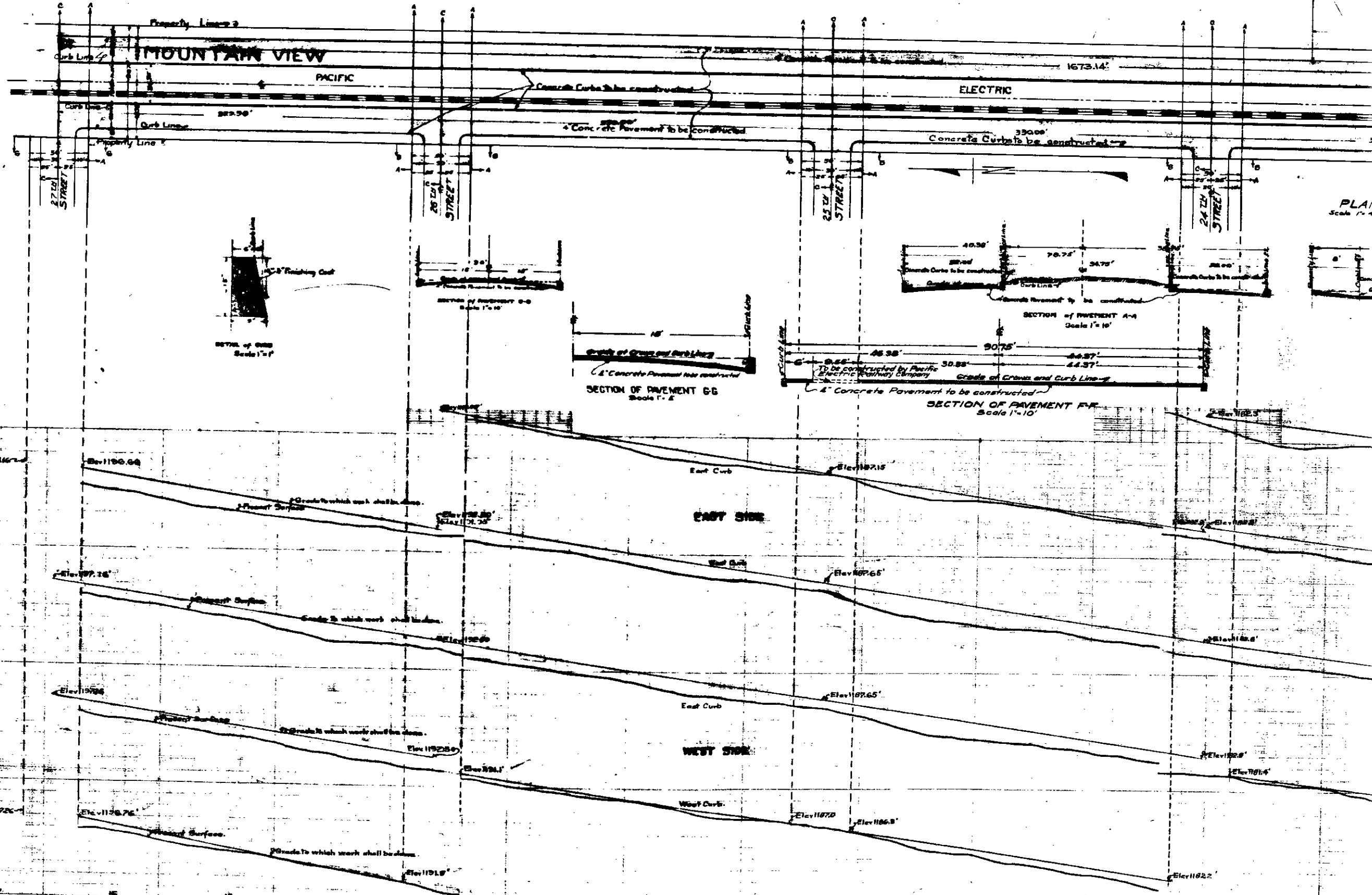

**Profile:**  
 Black Lines show present surface.  
 Red Lines show grade which work shall be done.  
 Scale:  
 Horizontal 1"=40'  
 Vertical 1"=4'  
 Title to Ordinance  
 Streets established by Ordinance No. 1154  
 Recorded in Book 15 Page 36 San Bernardino Co. Records  
 Also by Ord. No. 194 in Ord. Book 255 Page 378  
 All elevations in red ink are in feet and above a plane  
 which is 1045.28' below the city Bench Mark as  
 established by ordinance 563 of the City of San Bernardino.  
 Plans adopted Mar. 2, 1925.  
 Grade of Mountain View Ave. established by Ord. No. 1154  
 Grade of Highland Ave. established Decem. 21, 1914 Ordinance No. 393.

PLAN  
 Scale 1"=40'